

# WASHINGTON COUNTY HIGHWAY REGISTER

## FOREWORD

The County Highway Register is an attempt to search out, collate, and record all known information concerning the laying out of all roads in the county. It is required under the provisions of Section 83.01(7) (G) as amended by Chapter 183, Acts of the Legislature of 1957. This act specifically excludes incorporated places from the study, hence there will be found no information concerning city and village streets.

In looking for information, the following records have been searched:

1. Proceedings of the Board of County Commissioners, found in the office of the County Clerk.
2. The office of Secretary of State and the Congressional Records, both through the cooperation of the State Highway Commission.
3. The office of the County Court. Here no records apparently were ever filed as none could be found.
4. The office of each Town Clerk in the county. These offices were the best source of information.

Early records were often very sketchy, in some extreme cases merely locating the beginning and the end of a piece of road, occasionally several miles apart with no description of the route between them. Other descriptions involved the use of names of pioneer property owners, buildings, or trees now impossible to locate. Other roads were described by distances from topographical features, such as hills, streams, marshes or lakes, which were too general for anything more than an approximate location. In many cases the road was laid out on a section or quarter section line "or as near thereto as the country may permit." Usually no record was kept of these minor variations. Even where the road was laid on a specific line, the early construction men found natural obstructions too difficult to permit strict adherence to the record. In case of doubt effort has been made to abide by the best information available, at the same time considering the present location of the road. All descriptions which approximate a presently located highway have been indicated on the Register of Index Sheet, although only existing public roads have been shown on the map.

Often a piece of road was laid out more than once, either by the same or a different authority, and perhaps of different widths of right of way. In coloring the map and on the Index Sheet, the latest record has been used. It is felt that this is the legal one, as the Town Boards have the right to lay, alter and abandon any road at any time.

The Register does not concern itself with the Town Road System, the County Road System, nor the State Trunk System as such. The two latter are of comparatively recent origin and have been largely superimposed on the basic system of older roads. A few State or County Trunks have put on virgin locations. These are shown on the Register. Modern construction requires the purchase of wide right of way. Purchases vary in width from farm to farm, or indeed along different parts of the same farm. To include such a mass of detail in this report would be impossible. Where purchase of land were extensive, the road has been shown in brown and the reader referred to the project number. Right of way sketches are available under the project number in the office of the Register of Deeds, the State Highway Commission at Madison and Waukesha, and at the office of the County Highway Commissioner. In addition to the above variation, the stated width may vary in short sections due to purchases of very small bits of property here and there. Where available these have been noted in the Register Sheet. Most of these small purchases were not recorded at all in earlier years, particularly prior to about 1926. The study will therefore contain comparatively few references to the Grantor-Grantee Index.

Town records of laying out roads have been reproduced and are included. Many pages of Town Records concerning roads have not been reproduced, in the interest of brevity. Proceeding in lay a road often include pages for Petition, Notice of Hearing, Notice of Posting or adjournment, and award of damages. These may be necessary legal steps, but would add nothing to the clarity of the Register. Any interested person will find them in the same volume and on adjacent pages to the actual laying.

Information from the offices of County Clerk and Register of Deeds has not been reproduced, as it is readily available in the offices where kept

# STATE HIGHWAY COMM. OF WISCONSIN

## TOWN PLAT RECORD

Town - TRENTON County - WASHINGTON

Date of Last Corr.	State Trunks	County Trunks	Local Roads	Symbols
	▬▬▬	▬▬▬	▬▬▬	
1-1-56	8.25	17.81	57.17	Sch.
1-1-57	8.25	17.81	57.17	Cem.
1-1-58	8.25	17.81	57.54	
1-1-59	8.25	17.91	57.76	

*A City*

$57.76 - 0.45 = 57.31$

Certified as Correct By Town Chairman: \_\_\_\_\_

**WIDTHS OF RIGHT OF WAY**  
 GREEN - 4 RODS BY ORDER  
 BLUE - 4 RODS BY STATUTE, SEC. 80.08  
 RED - 3 RODS BY ORDER  
 YELLOW - MISCEL. SEE INDEX SHEET  
 BROWN - WIDTH VARIES  
 DASHED - LAID OUT, BUT NOT NOW OPEN

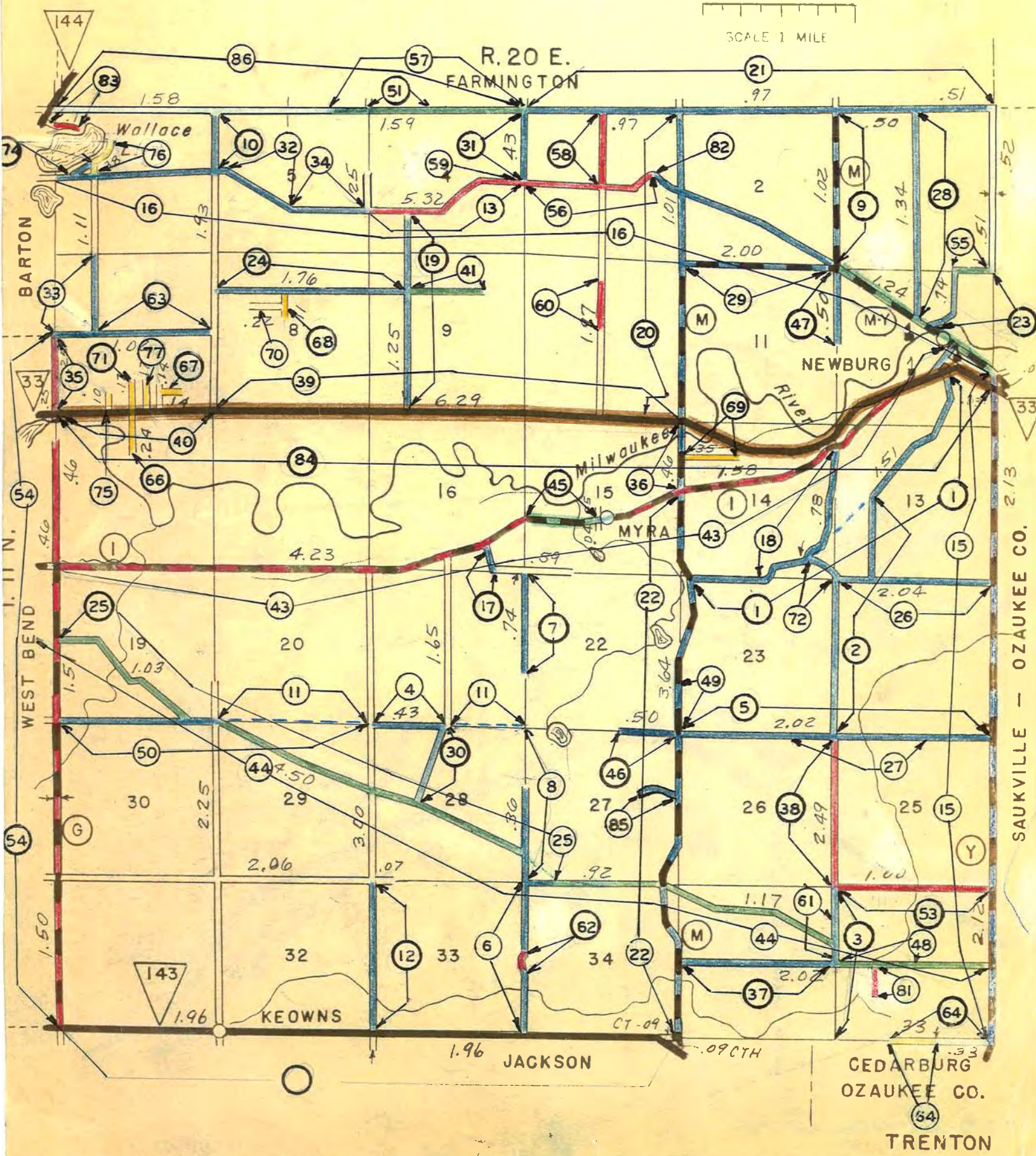

# NEWBURG

TOWN: TRENTON  
 COUNTY: WASHINGTON  
 UNINCORPORATED

WASHINGTON

DATE OF LAST COR.	STATE TRUNKS	CONN. STREET	COUNTY TRUNKS	LOCAL STREETS
1-1-56				1.22
1-1-57				1.22
1-1-58				1.22
1-1-59				1.14

CERTIFIED AS CORRECT

*Master*

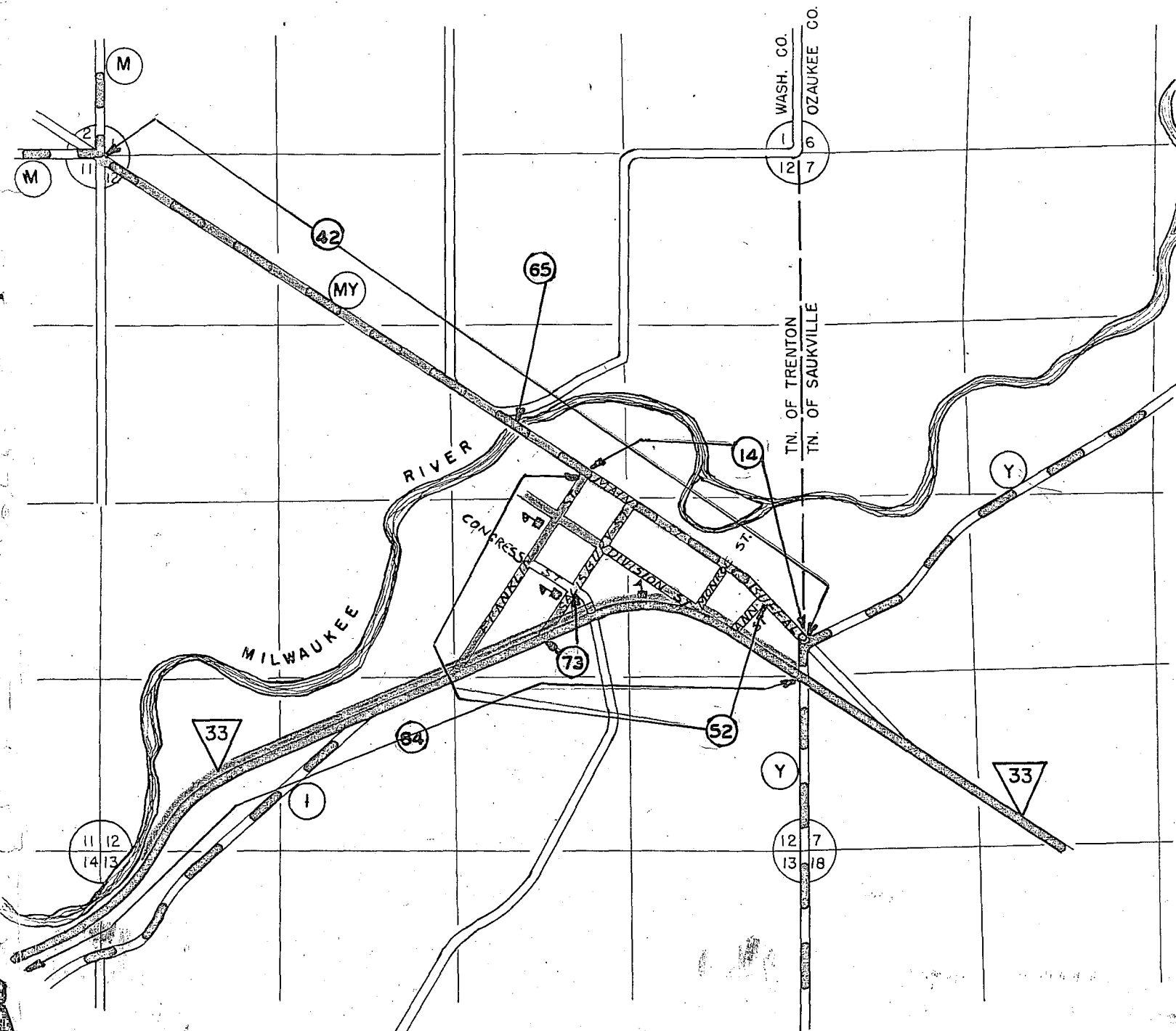

Map Index No.	Source of Information				Page No. in C.H.R.	Page Reproduced in C.H.R.	
	Office	Name of Record	Vol.	Page			
1	Town Clerk	Town Records	1	12	1	Yes	
2	Town Clerk	Town Records	1	13	2	Yes	
3	Town Clerk	Town Records	1	14	3	Yes	
4	Town Clerk	Town Records	1	14	3	Yes	
5	Town Clerk	Town Records	1	15	4	Yes	
6	Town Clerk	Town Records	1	15	4	Yes	
7	Town Clerk	Town Records	1	16	5	Yes	
8	Town Clerk	Town Records	1	16	5	Yes	
9	Town Clerk	Town Records	1	23	6	Yes	
10	Town Clerk	Town Records	1	23	6	Yes	
11	Town Clerk	Town Records	1	24	7	Yes	
12	Town Clerk	Town Records	1	24	7	Yes	
13	Town Clerk	Town Records	1	36,44,45	8,9,10	Yes	
14	Town Clerk	Town Records	1	36,45,46	8,10,11	Yes	
15	Town Clerk	Town Records	1	36,49	8,12	Yes	
16	Town Clerk	Town Records	1	50	13	Yes	
17	Town Clerk	Town Records	1	51	14	Yes	
18	Town Clerk	Town Records	1	58,142	15,32	Yes	
19	Town Clerk	Town Records	1	64,65	17,18	Yes	
20	Town Clerk	Town Records	1	76	19	Yes	
21	Town Clerk	Town Records	1	77	20	Yes	
22	Town Clerk	Town Records	1	80,81,82	23,24,25	Yes	
23	Town Clerk	Town Records	1	82,476	25,63	Yes	
24	Town Clerk	Town Records	1	83	26	Yes	
25	Town Clerk	Town Records	1	86,228	27,49	Yes	
26	Town Clerk	Town Records	1	105	28	Yes	
27	Town Clerk	Town Records	1	124	29	Yes	
28	Town Clerk	Town Records	1	126	30	Yes	
29	Town Clerk	Town Records	1	133	31	Yes	
30	Town Clerk	Town Records	1	142	32	Yes	
31	Town Clerk	Town Records	1	143	33	Yes	
32	Town Clerk	Town Records	1	156	35	Yes	
33	Town Clerk	Town Records	1	156	35	Yes	
34	Town Clerk	Town Records	1	156,157	35,36	Yes	

Map Index No.	Source of Information			Page No. in C.H.R.	Page Reproduced in C.H.R.
	Office	Name of Record	Vol.		
35	Town Clerk	Town Records	1	169	37 Yes
36	Town Clerk	Town Records	1	184	38 Yes
37	Town Clerk	Town Records	1	187	39 Yes
38	Town Clerk	Town Records	1	192	40 Yes
			2	85, 86, 87, 89	77, 78, 79, 83 Yes
39	Town Clerk	Town Records	1	212	41 Yes
40	Town Clerk	Town Records	1	202	42 Yes
41	Town Clerk	Town Records	1	202, 203	42 Yes
42	Town Clerk	Town Records	1	202, 204	42, 43 Yes
43	Town Clerk	Town Records	1	516	43, 43A Yes
44	Town Clerk	Town Records	1	214, 215, 216	44, 45, 46 Yes
45	Town Clerk	Town Records	1	223, 224	47, 48 Yes
46	Town Clerk	Town Records	1	239, 240	50, 51 Yes
47	Town Clerk	Town Records	1	276	52 Yes
48	Town Clerk	Town Records	1	284, 285	53, 54 Yes
49	Town Clerk	Town Records	1	321	55 Yes
50	Town Clerk	Town Records	1	325, 327	56, 58 Yes
51	Town Clerk	Town Records	1	326	57 Yes
				18	80 Yes
52	Town Clerk Reg. Deeds	Town Records Plat Book	1	450, 451	59, 60 Yes
			1	7	No
53	Town Clerk	Town Records	1	472, 473	61, 62 Yes
54	Town Clerk	Town Records	1	504	64 Yes
55	Town Clerk	Town Records	1	204	43 Yes
56	Town Clerk	Town Records	1	533, 534	65, 66 Yes
			2	535, 1, 2	67, 72, 73 Yes
57	Town Clerk	Town Records	1	570, 571	68, 69 Yes
58	Town Clerk	Town Records	1	577, 578	70, 71 Yes
59	Town Clerk	Town Records	2	28, 29, 35, 36	74, 75, 76 Yes
60	Town Clerk	Town Records	7	93, 94	84, 85 Yes
61	Town Clerk	Town Records	9	5	86 Yes
62	Town Clerk	Town Records	9	11, 36	87, 89, 90 Yes
63	Town Clerk	Town Records	9	21	88 Yes
64	Town Clerk	Town Records	9	121	91 Yes
	Town Clerk	Town Records	10	312	110 Yes

Map Index No.	Source of Information				Page No. in C.H.R.	Page Reproduced in C.H.R.
	Office	Name of Record	Vol.	Page		
65	Town Clerk	Town Records	9	121	92	Yes
66	Town Clerk	Town Records	10	-	93	Yes
			10	24	103	Yes
67	Town Clerk	Town Records	10	2	94	Yes
68	Town Clerk	Town Records	10	2	94	Yes
69	Town Clerk	Town Records	10	4	95	Yes
70	Town Clerk Rec. Deeds	Town Records Plat Book	10	16	96	Yes
			9	13	-	No
71	Town Clerk	Town Records	10	17	97	Yes
72	Town Clerk	Town Records	10	308, 309	98, 99	Yes
73	Town Clerk	Town Records	10	310	100	Yes
74	Town Clerk	Town Records	10	367	101	Yes
75	Town Clerk	Town Records	10	495	102	Yes
76	Town Clerk Rec. Deeds	Town Records Plat Book	8	241	104	Yes
			4	43		No
77	Town Clerk	Town Records	10	18, 19	105, 106	Yes
78	Town Clerk	Town Records	10	22	107	Yes
79	Town Clerk	Town Records	10	22, 23	107, 108	Yes
80	Town Clerk	Town Records	10	26	109	Yes
81	Town Clerk	Town Records	10	312	110	Yes
82	Town Clerk	Town Records	10	335, 336	111, 111A	Yes
83	Town Clerk	Town Records	10	356, 357	112, 113	Yes
84	State by County Hwy. Comm.	F.A.P. 444			None	No
85	Town Clerk	Town Records	10		114	Yes
86	Town Clerk of Farmington	Town Records	11	115	115, 116	Yes

Map Index No.	Instrument	Name of Highway	Sections of Land Effected	Grantor-Grantee Index		Width		Date Laid
				vol.	Page	Feet	Authority	
1	Town Order		13,14,23			66	Statute	6/27/1848
2	Town Order		13,23,24			66	Statute	6/27/1848
3	Town Order		35,36			66	Statute	7/1/1848
4	Town Order		21,28			66	Statute	6/27/1848
5	Town Order		23,24,25,26			66	Statute	7/27/1848
6	Town Order		33,34			66	Statute	7/1/1848
7	Town Order		15,16,21,22			66	Statute	6/27/1848
8	Town Order		27,28			66	Statute	6/27/1848
9	Town Order	C.T.H. "M"	1,2			66	Statute	3/26/1849
10	Town Order		5,6,			66	Statute	3/27/1849
11	Town Order		20,29,21,28			66	Statute	3/28/1849
12	Town Order		32,33			66	Statute	3/29/1849
13	Town Order		4			49½	Order	4/30/1849
14	Town Order	C.T.H. "MY"	12 See item	42		49½	Order	4/28/1849
15	Town Order	C.T.H. "Y"	12,13,24,25 36			66	Statute	5/29/1849
16	Town Order		2-5 Incl. 11,12			66	Statute	5/29/1849
17	Town Order		16			66	Statute	5/29/49
18	Town Order		13,14			66	Statute	1/3/1850
19	Town Order		4,9			66	Statute	3/28/1850
20	Town Order	C.T.H. "M" in part	2,3,10,11			66	Statute	3/28/1850
21	Town Order		1,2,3			66	Statute	5/6/1850
22	Town Order	C.T.H. "M"	14,15,22,23 26,27,34,35			66	Statute	6/17/1850
23	Town Order		1,12 See item 55			66	Statute	6/18/1850
24	Town Order		7,8,9			66	Statute	7/11/1850
25	Town Order		19,30,29,28 See item 44			66	Statute	1/22/1851
26	Town Order		13,24			66	Statute	5/24/1851
27	Town Order		23,24,25,26			66	Statute	7/15/1852
28	Town Order		1,12			66	Statute	10/4/1852
29	Town Order	C.T.H. "M"	2,11			66	Statute	2/10/1853
30	Town Order		28			66	Statute	6/13/1853
31	Town Order		3,4			66	Statute	8/13/1853

Map Index No.	Instrument	Name of Highway	Sections of Land Effected	Grantor-Grantee Index		Width		Date Laid
				Vol.	Page	Feet	Authority	
32	Town Order		5			66	Statute	10/23/54
33	Town Order		7			66	Statute	10/23/54
34	Town Order		5			66	Statute	10/23/54
35	Town Order		7 See item 54			66	Statute	9/29/55
36	Town Order	C.T.H. "M"	14,15			66	Statute	5/26/1856
37	Town Order		35			66	Statute	10/23/56
38	Town Order		25,26			66 49½	Order Order	4/17/57 2/23/84
39	Town Order	S.T.H. "33"	8,9,10,15,16 17 See item 84			66	Order	2/24/58
40	Town Order	S.T.H. "33"	7,18 See item 84			66	Order	6/9/57
41	Town Order		9			66	Order	6/9/57
42	Town Order		12			66	Order	7/15/57
43	Town Order	C.T.H. "I"	14,15,16,17 20,18,19			49½	Order	11/6/57
44	Town Order		19,30,29,28 27,34,35,36			66	Order	4/8/40
45	Town Order		15			66	Order	9/11/58
46	Town Order		22,27			66	Statute	8/2/59
47	Town Order		11,12			66	Statute	5/22/61
48	Town Order		36			66	Order	12/3/61
49	Town Order		22,23			66	Statute	4/30/64
50	Town Order		19,20,30,29			66	Statute	7/13/64
51	Town Order		4 See item 57			66	Statute	7/9/64
52	Town Order		12			66	Statute	1/29/70
53	Town Order		25,36			49½	Order	5/14/70
54	Town Order	C.T.H. "G"	7,18,19,30, 31			49½	Order	10/28/72
55	Town Order		1,12			66	Order	7/1/57
56	Town Order		3			49½	Order	1/23/57
57	Town Order		4,5			66	Order	12/23/76
58	Town Order		3			49½	Order	1/6/77
59	Town Order		3,4			49½	Order	9/30/77
60	Town Order		10			49½	Order	2/6/92
61	Town Order		35,36			66	Statute	10/26/10
62	Town Order		33,34			49½	Order	4/30/1913



Map Index No.	Instrument	Name of Highway	Sections of Land Effected	Grantor-Grantee Index		Width		Date	
				Vol.	Page	feet	Authority		
63	Town Order		7			66	Statute	3/1/19	
						-	Order	8/10/19	
64	Town Order	Abandon. See Page	36			8 3/4	Order	6/8/33	
	Town Order		110						
65	Town Order		12			Irreg	Order	9/30/20	
66	Town Order		18			80	Donation	10/4/54	
67	Town Order		7			60	Donation	10/2/1955	
68	Town Order		8			80	Donation	10/3/55	
69	Town Order		14			50	Donation	12/29/56	
70	Town Order		8			40	Donation	12/20/56	
71	Town Order		7			80	Donation	-	
72	Town Order		14			66	Statute	7/31	
73	Town Order		12			66	Statute	1/6/31	
74	Town Order		6			66	Statute	4/16/38	
75	Town Order		7			50	Donation	8/6/51	
76	Town Order		6			33	Donation	7/19/26	
77	Town Order		6			-	Donation	5/6/57	
78	Not open								
79	Order		6			66	Dedication	1/23/58	
80	Not open								
81	Town Order		36			49 1/2	Order	8/10	
82	Order		3			Irreg.	Order	5/4/35	
83	Order		6			49 1/2	Order	4/17/37	
84	Order		7/12 Inc. 13-18 Inc.			Var.	Reloc. Order		
85	Order		27			66	Statute	10/4/54	
86	Order		4,5,6			66	Statute	6/10/1892	
	The above is for division of maintenance						Prob- able		