

# WASHINGTON COUNTY HIGHWAY REGISTER

## FOREWORD

The County Highway Register is an attempt to search out, correlate, and record all known information concerning the laying out of all roads in the county. It is required under the provisions of Section 83.01(7) (G) as amended by Chapter 183, Acts of the Legislature of 1957. This act specifically excludes incorporated places from the study, hence there will be found no information concerning city and village streets.

In looking for information, the following records have been searched:

1. Proceedings of the Board of County Commissioners, found in the office of the County Clerk.
2. The office of Secretary of State and the Congressional Records, both through the cooperation of the State Highway Commission.
3. The office of the County Court. Here no records apparently were ever filed as none could be found.
4. The office of each Town Clerk in the county. These offices were the best source of information.

Early records were often very sketchy, in some extreme cases merely locating the beginning and the end of a piece of road, occasionally several miles apart with no description of the route between them. Other descriptions involved the use of names of pioneer property owners, buildings, or trees now impossible to locate. Other roads were described by distances from topographical features, such as hills, streams, marshes or lakes, which were too general for anything more than an approximate location. In many cases the road was laid out on a section or quarter section line "or as near thereto as the country may permit." Usually no record was kept of these minor variations. Even where the road was laid on a specific line, the early construction men found natural obstructions too difficult to permit strict adherence to the record. In case of doubt effort has been made to abide by the best information available, at the same time considering the present location of the road. All descriptions which approximate a presently located highway have been indicated on the Register of Index Sheet, although only existing public roads have been shown on the map.

Often a piece of road was laid out more than once, either by the same or a different authority, and perhaps of different widths of right of way. In coloring the map and on the Index Sheet, the latest record has been used. It is felt that this is the legal one, as the Town Boards have the right to lay, alter and abandon any road at any time.

The Register does not concern itself with the Town Road System, the County Road System, nor the State Trunk System as such. The two latter are of comparatively recent origin and have been largely superimposed on the basic system of older roads. A few State or County Trunks have put on virgin locations. These are shown on the Register. Modern construction requires the purchase of wide right of way. Purchases vary in width from farm to farm, or indeed along different parts of the same farm. To include such a mass of detail in this report would be impossible. Where purchase of land were extensive, the road has been shown in brown and the reader referred to the project number. Right of way sketches are available under the project number in the office of the Register of Deeds, the State Highway Commission at Madison and Waukesha, and at the office of the County Highway Commissioner. In addition to the above variation, the stated width may vary in short sections due to purchases of very small bits of property here and there. Where available these have been noted in the Register Sheet. Most of these small purchases were not recorded at all in earlier years, particularly prior to about 1926. The study will therefore contain comparatively few references to the Grantor-Grantee Index.

Town records of laying out roads have been reproduced and are included. Many pages of Town Records concerning roads have not been reproduced, in the interest of brevity. Proceeding in lay a road often include pages for Petition, Notice of Hearing, Notice of Posting or adjournment, and award of damages. These may be necessary legal steps, but would add nothing to the clarity of the Register. Any interested person will find them in the same volume and on adjacent pages to the actual laying.

Information from the offices of County Clerk and Register of Deeds has not been reproduced, as it is readily available in the offices where kept

# STATE HIGHWAY COMM. OF WISCONSIN

## TOWN PLAT RECORD

Town - ERIN                      County - WASHINGTON

Date of Last Corr.	State Trunks	County Trunks	Local Roads	Symbols
	▬▬▬	▬▬▬	▬▬▬	
1-1-56	10.22	14.18	40.93	Sch. <span style="font-size: small;">■</span>
1-1-57	10.22	14.18	41.56	Cem. <span style="font-size: small;">⊕</span>
1-1-58	10.22	14.18	41.56	
1-1-59	10.25	14.22	41.72	

41.72 - 0.23 = 41.49

Certified as Correct By Town Chairman: \_\_\_\_\_

**WIDTHS OF RIGHT OF WAY**  
**GREEN - 4 RODS BY ORDER**  
**BLUE - 4 RODS BY STATUTES, SEC. 80.08**  
**RED - 3 RODS BY ORDER**  
**YELLOW - MISCEL. SEE INDEX SHEET**  
**BROWN - WIDTH VARIES**  
**DASHED - LAID OUT, BUT NOT NOW OPEN**

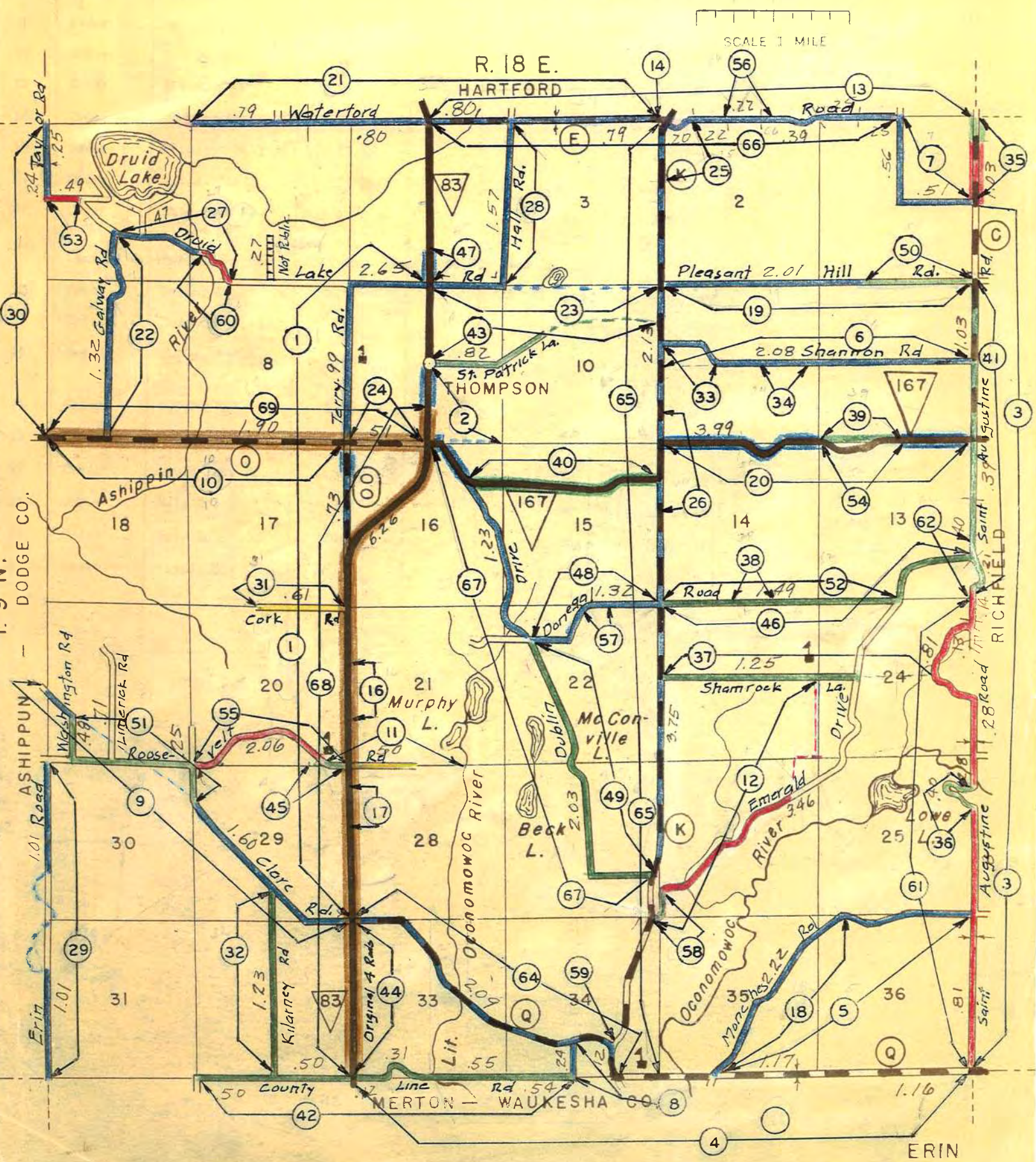

Map Index No.	Instrument	Name of Highway	Sections of Land Effected	Grant-Grantee		Width		
				Vol.	Page	Feet	Auth.	Date
1	Order	S.T.H. "83" in part	4,8,9,16,17 20,21,28,29			66	Stat.	7/7/1846
2	Order	S.T.H. "83" in pt.	9,16			66	Stat.	7/8/1846
3		St. Augustine Rd. and in part C.T.H. "C"	1,12,13,24 25,36					10/9/1847
4	Order	C.T.H. "Q" in pt.	33,34,35,36					10/8/1847
5	Order	Monches Rd.	25,35,36			66	Stat.	2/2/1848
6	Order	Shannon Rd.	11,12			66	Stat.	2/7/1848
7	Order	Powder Hill Rd.	1			66	Stat.	2/4/1848
8	Order		34			66	Stat.	2/5/1848
9	Order	Clare Rd.	19,29,30,32			66	Stat.	2/8/1848
10	Order	C.T.H. "O"	7,8,17,18			66	Stat.	7/6/1848
11	Order	Roosevelt Dr.	21,28,20,29			33	Order	11/1/1848
12	Order	Emerald Dr.	23,24,26			49½	Stat.	11/27/1848
13	Order	Waterford Rd. C.T.H. "E" in pt.	1,2,3,4			66	Stat.	11/28/1848
14	Order	Waterford Rd.	2			66	Stat.	11/28/1848
15	Order					66	Stat.	
16	Order	S.T.H. "83"	20,21			66	Stat.	12/29/1849
17	Order	S.T.H. "83"	28,29			66	Stat.	12/29/1849
18	Order	Monches Rd.	35,36			66	Stat.	1/5/1850
19	Order	Pleasant Hill Rd.	1,2,11,12			66	Stat.	2/12/1854
20	Order	S.T.H. "167"	11,12,13,14			66	Stat.	2/2/1850
21	Order	Waterford Rd. C.T.H. "E"	3,4,5			66	Stat.	3/2/1850
Town of Hartford shows their south town line to be 49½ feet in width								
22	Order	Galway Rd.	6,7,			66	Stat.	3/15/1850
23	Order	Shannon Rd.	11			66	Stat.	3/21/1850
24	Order	C.T.H. "O"	9,16			66	stat.	3/21/1850
						66	Order	6/21/1857
25	Order	C.T.H. "K"	2,3,			66	Stat.	7/4/1851
26	Order	C.T.H. "K"	10,11,14,15			66	Stat.	7/4/1851
27	Order	Druid Lake Rd.	5,6,			66	Stat.	10/16/1851
28	Order	Hall Rd.	3,4			66	Stat.	11/16/1851
29	Order	Erin Rd.	30,34			66	Stat.	2/21/1853
30	Order	Taylor Rd.	6,7			66	Stat.	3/26/1853

Map Index No.	Instrument	Name of Highway	Sections of Land Effected	Grant-Grantee		Width	
				Vol.	Page	Feet	Auth. Date
31	Order	Cork Rd.	17,20			16½ 33	Order 3/31/1854 Order 6/13/1878
32	Order	Killarney Rd.	29,32			66	Order 3/31/1854
33	Order	Shannon Rd.	11			66	Stat. 4/9/1854
34	Order	Shannon Rd.	11			66	Stat. 4/9/1854
35	Order	St. Augustine Rd.	1			24.5 66	Order 12/22/1906
36	Order	St. Augustine Rd.	25			66	Order 4/1/1854
37	Order	Shamrock Dr.	23,24			66	Order 1/13/1857
38	Order	Donegal Rd.	14,23			33	Order 7/7/1854
39	Order	S.T.H. "167"	12,13			66	Order 11/1/1854
40	Order	S.T.H. "167"	15,16			66	Order 12/18/1854
41	Order	St. Augustine Rd. C.T.H. "C"	12,13			66	Order 11/30/1855
42	Order	County Line Rd.	32,33,34			66	Order 5/24/1856
43	Order	Druid Lake Rd.	3,4,9,10			66	Order 6/19/1856
44	Order	S.T.H. "83"	32,33			66	Order 1/13/1857
45	Order	Roosevelt Dr.	20,29			66	Order 11/17/1860
46	Order	Donegal Rd.	13,14,23,29			66	Order 9/15/1857
	Above discontinued						Order 6/3/1858
	Order	Donegal Rd.	13,14,23,29			66	Order 6/14/1858
47	Order	S.T.H. "83"	4			66	Stat. 11/4/1858
48	Order	Donegal Rd.	15,22			66	Stat. 3/10/1859
49	Order	Dublin Rd.	22,27			66	Order 11/7/1859
50	Order	Pleasant Hill Rd.	1,12			66	Order 2/24/1861
51	Order	Washington Rd. Roosevelt Rd. Clare Rd.	19,29,30			66	Order 3/31/1861
52	Order	Donegal Rd.	13,14,23,24			66	Order 1/29/1861
53	Order	Druid Lake Rd.	6			49½	Order 1/15/1862
54	Order	S.T.H. "167"	12,13			66	Order 12/4/1866
55	Order	Roosevelt Dr.	20,29			49½	Order 6/29/1867
56	Order	Waterford Rd.	2			66	Stat. 6/22/1868
57	Order	Donegal Rd.	22			66	Stat. 5/8/1877
58	Order	Emerald Dr.	27,34			49½	Order 2/8/1876
59	Order	C.T.H. "Q" & "K"	34			Var.	Order 5/24/1883
60	Order	Druid Lake Rd.	5			49½	Order 6/17/1895
61	Order	St. Augustine Rd.	24,25,36			49½ 66	Order 3/17/1855 Stat. 1845

Map Index No.	Instrument	Name of Highway	Sections of Land Effectuated	Grantr-Grantee		Width	
				Vol.	Page	Feet	Auth. Date
62	Order	St. Augustine Rd.	13			66	Stat. 9/19/1853
63	Order		Not Open				
64	Order	C.T.H. "Q"	28,33,34			66	Stat. 7/7/1846
65	Order	C.T.H. "K"	2,3,10,11,14 15,22,23,26 27,34,35			66	Stat. 1/3/1845
66	Order	Waterford Rd.	1,2,3,4			66	Stat. 12/25/1843
67	Order	Dublin Dr. & S.T.H. "167"	16,22,27			66	Stat. 4/5/1846
68	Order(Reloc)	S.T.H. "83"	9,16,17,20,21 28,29,32,33			Var.	Order 1941
69	Reloc.Ord.	C.T.H. "O"	7,8,9,16 17,18			Var.	Order 1955

Map Index No.	Source of Information				Page in C.H.R.	Page Shown in C.H.R.	
	Office	Name of Record	Vol.	Page			
1	Town Clerk	Proceedings	1	6,7	1,2	Yes	
2	Town Clerk	Proceedings	1	7	2	Yes	
3	Town Clerk	Proceedings	1	15	3	Yes	
4	Town Clerk	Proceedings	1	16	4	Yes	
5	Town Clerk	Proceedings	1	18,19	5,6	Yes	
6	Town Clerk	Proceedings	1	19	6	Yes	
7	Town Clerk	Proceedings	1	19	6	Yes	
8	Town Clerk	Proceedings	1	20	7	Yes	
9	Town Clerk	Proceedings	1	20	7	Yes	
10	Town Clerk	Proceedings	1	27	8	Yes	
11	Town Clerk	Proceedings	1	27,28	8,9	Yes	
12	Town Clerk	Proceedings	1	28,29	9,10	Yes	
			1	31,32	12	Yes	
13	Town Clerk	Proceedings	1	29	10	Yes	
14	Town Clerk	Proceedings	1	29,30	10,11	Yes	
15	Town Clerk	Proceedings	1		12	Yes	
16	Town Clerk	Proceedings	1	35	13	Yes	
17	Town Clerk	Proceedings	1	35	13	Yes	
18	Town Clerk	Proceedings	1	36	14	Yes	
19	Town Clerk	Proceedings	1	36	14	Yes	
20	Town Clerk	Proceedings	1	37	15	Yes	
21	Town Clerk	Proceedings	1	37,38	15,16	Yes	
22	Town Clerk	Proceedings	1	38,39	16,17	Yes	
23	Town Clerk	Proceedings	1	39	17	Yes	
24	Town Clerk	Proceedings	1	39,102	17	Yes	
25	Town Clerk	Proceedings	1	44	18	Yes	
26	Town Clerk	Proceedings	1	44	18	Yes	
27	Town Clerk	Proceedings	1	50	20	Yes	
28	Town Clerk	Proceedings	1	50	20	Yes	
29	Town Clerk	Proceedings	1	54,55	21	Yes	
30	Town Clerk	Proceedings	1	54,55	21	Yes	
31	Town Clerk	Proceedings	1	63	22	Yes	
	Town Clerk	Proceedings	1	206,207	60	Yes	
32	Town Clerk	Proceedings	1	63	22	Yes	
33	Town Clerk	Proceedings	1	64	23	Yes	
34	Town Clerk	Proceedings	1	64	23	Yes	

Map Index No.	Source of Information				Page No. in C.H.R.	Page Shown in C.H.R.	
	Office	Name of Record	Vol.	Page			
35	Town Clerk of Richfield	Proceedings	2	131	24	Yes	
	No. 35 was found in Richfield. Vol. & Page is Richfield numbering						
36	Town Clerk	Proceedings	1	65	25,26	Yes	
	Town Clerk	Proceedings	4	96	64	Yes	
	Book 4 is from the Town of Richfield. Vol. & Page are Richfield Numbering.						
37	Town Clerk	Proceedings	1	95	26	Yes	
38	Town Clerk	Proceedings	1	71	29	Yes	
39	Town Clerk	Proceedings	1	76	31	Yes	
40	Town Clerk	Proceedings	1	77	32	Yes	
41	Town Clerk	Proceedings	2	56	33	Yes	
	Town Clerk	Proceedings	1	82	34,35	Yes	
	Book 2 is from Town of Richfield. Vol. & Page are Richfield numbering.						
42	Town Clerk	Proceedings	1	91	36	Yes	
43	Town Clerk	Proceedings	1	93,94	37,38	Yes	
44	Town Clerk	Proceedings	1	96	39	Yes	
45	Town Clerk	Proceedings	1	141	39	Yes	
46	Town Clerk	Proceedings	1	103,104 113	41,42,43 44	Yes Yes	
47	Town Clerk	Proceedings	1	116	45	Yes	
48	Town Clerk	Proceedings	1	119	46	Yes	
49	Town Clerk	Proceedings	1	129,130	47,48	Yes	
50	Town Clerk	Proceedings	1	132	50	Yes	
51	Town Clerk	Proceedings	1	136,137	51,52	Yes	
52	Town Clerk	Proceedings	1	142,143	53,54	Yes	
53	Town Clerk	Proceedings	1	150	55	Yes	
54	Town Clerk	Proceedings	1	169	56	Yes	
55	Town Clerk	Proceedings	1	173,174	57	Yes	
56	Town Clerk	Proceedings	1	176	58	Yes	
57	Town Clerk	Proceedings	1	201	58	Yes	
58	Town Clerk	Proceedings	1	195,196 68,69	59 27,28	Yes Yes	
59	Town Clerk	Proceedings	1	244-246 45,46	19,61	Yes	
60	Town Clerk	Proceedings	1	300	63	Yes	
61	Town Clerk	Proceedings	2	9	64	Yes	
	Town Clerk	Proceedings	4	3			
	Books 2 & 4 are from Town of Richfield records. Vols. & Pages are Rich.numb.						
62	Town Clerk	Proceedings	4	83,84	65,66	Yes	
	Town of Richfield. Vol. & Page are Richfield numbering.						
63	Town Clerk	Proceedings	1	68	27	Yes	
	Not open						

Map Index No.	Source of Information				Page No. in C.H.R.	Page Shown in C.H.R.
	Office	Name of Record	Vol.	Page		
64	Town Clerk	Proceedings	1	6,7	1,2	Yes
65	County Clerk	Co. Commr's Proc.	A	101,117	None	No *
66	County Clerk	Co. Commr's Proc.	A	57,60	None	No *
67	County Clerk	Co. Commr's Proc.	A	179,187	None	No *
68	County Clerk St. Hwy. Comm.	Highway Plans	Proj.	2566	None	No
69	County Clerk St. Hwy. Comm.	Highway Plans	Proj.	\$ 0141(8)	None	No

\* The Board of County Commissioners Volume A pages have been scanned and can be found on the highway registry books webpage under the listed township.