



JACKSON BENCHMARKS

This is a PDF of **all mapped Benchmarks 1997 forward** in T10E R20W ordered by section number.

For pre-1997 benchmarks, click to view [index map and scanned images of benchmark sheets.](#)

Please scroll to your desired benchmark.



For more information or to report problems, contact:
Scott M. Schmidt, PE, RLS
Washington County Engineer/Surveyor
Washington County Public Agency Center (PAC)
333 East Washington St, Suite 2300
P.O. Box 2003
West Bend, WI 53095-2003
Phone: 262-335-6881
Fax: 262-335-4171
Email: scott.schmidt@co.washington.wi.us

RECORD OF VERTICAL CONTROL STATION

SECTION 3 T. 10 N. R. 20 E. WASHINGTON COUNTY, WISCONSIN

BENCH MARK NO.: 114 ELEVATION 869.390

BM SET BY: AERO-METRIC, INC. YEAR: 2004

BM CONTROL SURVEY BY: AERO-METRIC, INC. YEAR: 2004

DATUM: NATIONAL GEODETIC VERTICAL DATUM OF 1929

CONTROL ACCURACY: SECOND ORDER, CLASS II

LOCATION SKETCH:

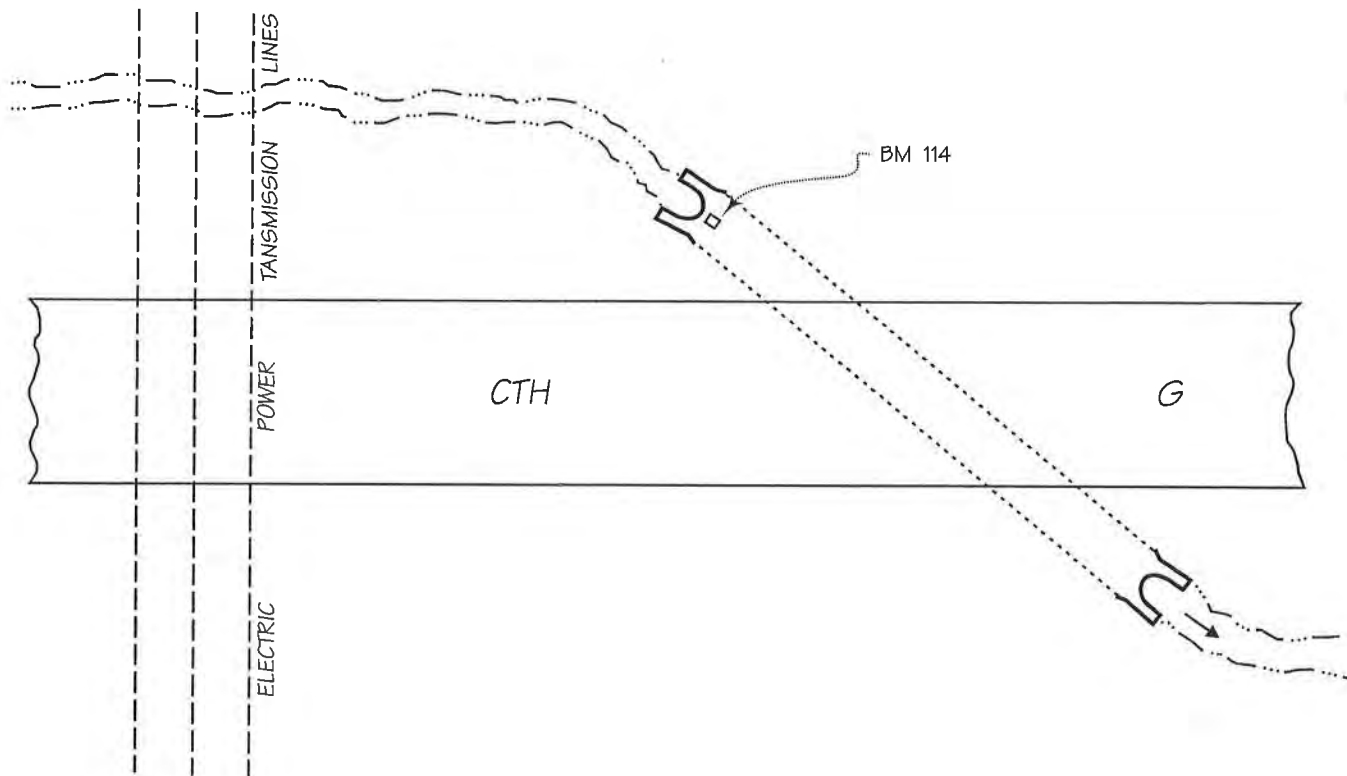
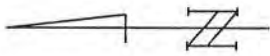

DETAILED DESCRIPTION:

BM 114 is a chiseled square in the top of the northeast end of a 36" diameter concrete culvert. The benchmark is 450'± north of the drive to house No. 4630 and 225'± south of the west quarter corner of Section 3, T10N R20E.

RECOVERED BY: SEWRPC DATE: 4 APRIL 2005

RECORD OF VERTICAL CONTROL STATION

SECTION 4 T. 10 N. R. 20 E. WASHINGTON COUNTY, WISCONSIN

BENCH MARK NO.: 113 ELEVATION 856.095

BM SET BY: AERO-METRIC, INC. YEAR: 2004

BM CONTROL SURVEY BY: AERO-METRIC, INC. YEAR: 2004

DATUM: NATIONAL GEODETIC VERTICAL DATUM OF 1929

CONTROL ACCURACY: SECOND ORDER, CLASS II

LOCATION SKETCH:

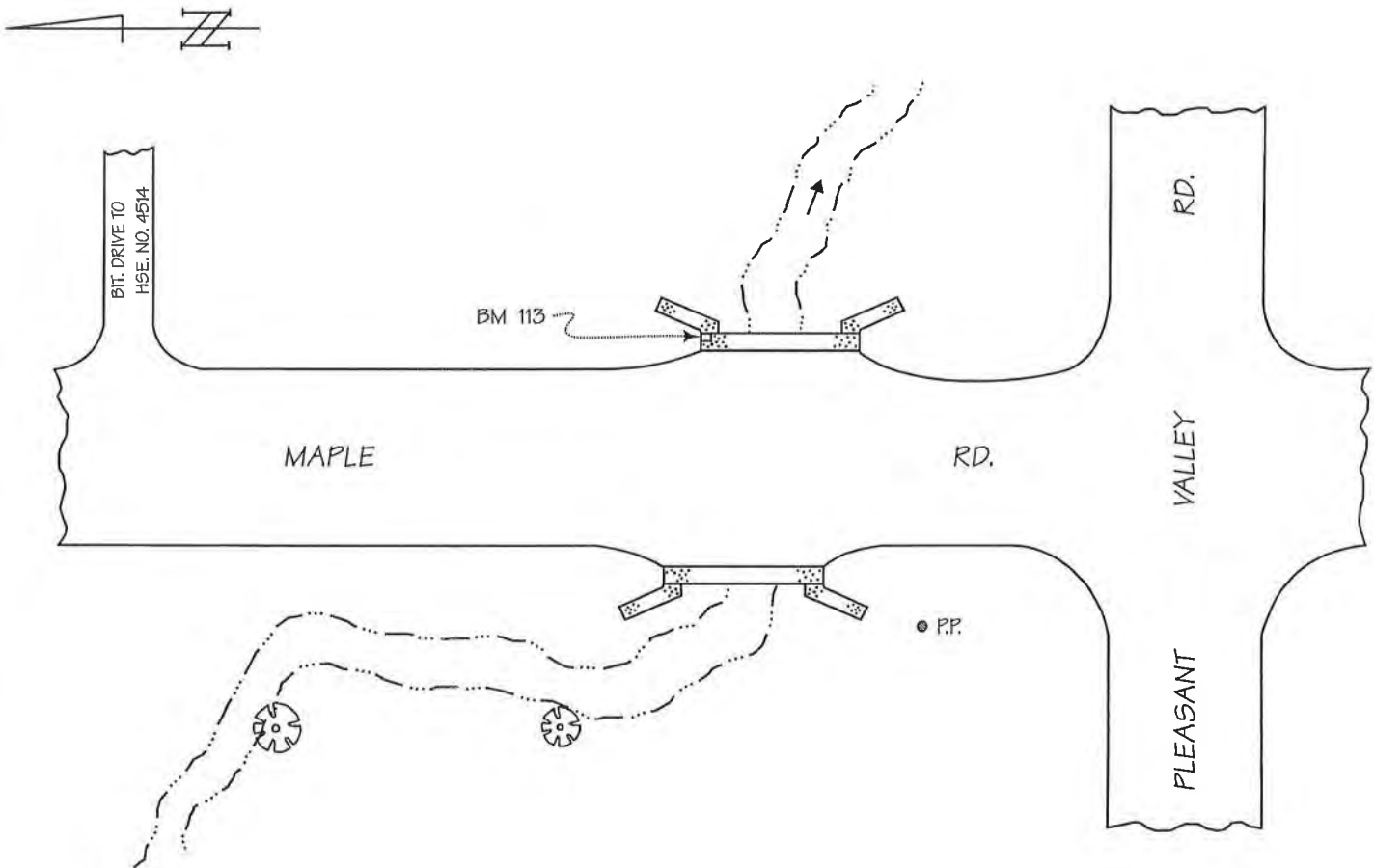

DETAILED DESCRIPTION:

BM 113 is a chiseled square in the top of the northeast corner of the concrete endwall for bridge.

RECOVERED BY: SEWRPC DATE: 4 APRIL 2005

RECORD OF VERTICAL CONTROL STATION

SECTION 4 T. 10 N. R. 20 E. WASHINGTON COUNTY, WISCONSIN
BENCH MARK NO.: 117 ELEVATION 850.551
BM SET BY: AERO-METRIC, INC. YEAR: 2004
BM CONTROL SURVEY BY: AERO-METRIC, INC. YEAR: 2004
DATUM: NATIONAL GEODETIC VERTICAL DATUM OF 1929
CONTROL ACCURACY: SECOND ORDER, CLASS II

LOCATION SKETCH:

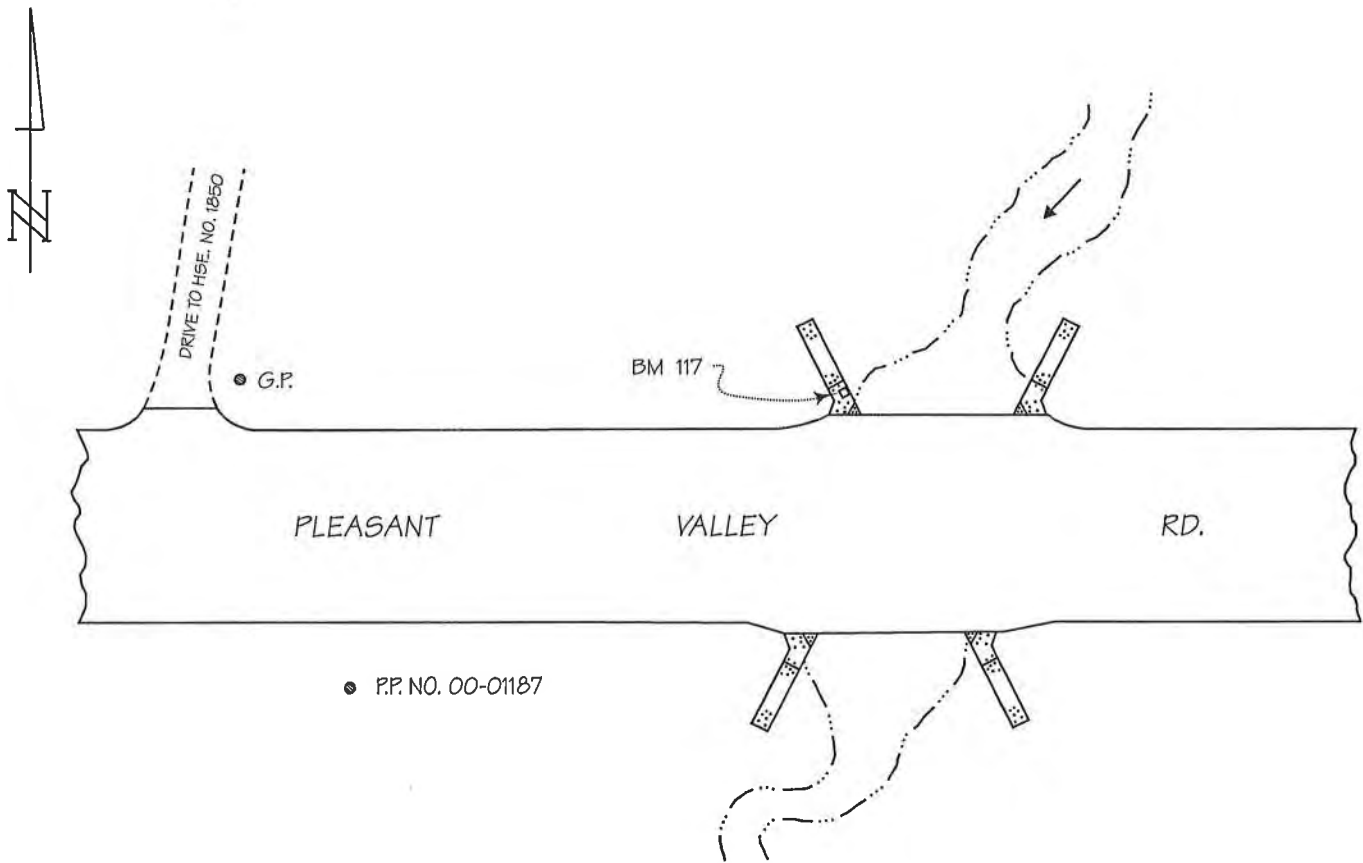

DETAILED DESCRIPTION:

BM 117 is a chiseled square in the top of the southeast end of the northwest wingwall for bridge.

RECOVERED BY: SEWRPC DATE: 4 APRIL 2005

RECORD OF VERTICAL CONTROL STATION

SECTION 7 T. 10 N. R. 20 E. WASHINGTON COUNTY, WISCONSIN

BENCH MARK NO.: 118 ELEVATION 871.858

REFERENCE BENCH MARK NO.: B-66-104-90 ELEVATION 872.391

BM /RBM SET BY: AERO-METRIC, INC./WisDOT YEAR: 2004/1990

BM/RBM CONTROL SURVEY BY: AERO-METRIC, INC./SEWRPC YEAR: 2004/2005

DATUM: NATIONAL GEODETIC VERTICAL DATUM OF 1929

CONTROL ACCURACY: SECOND ORDER, CLASS II

LOCATION SKETCH:

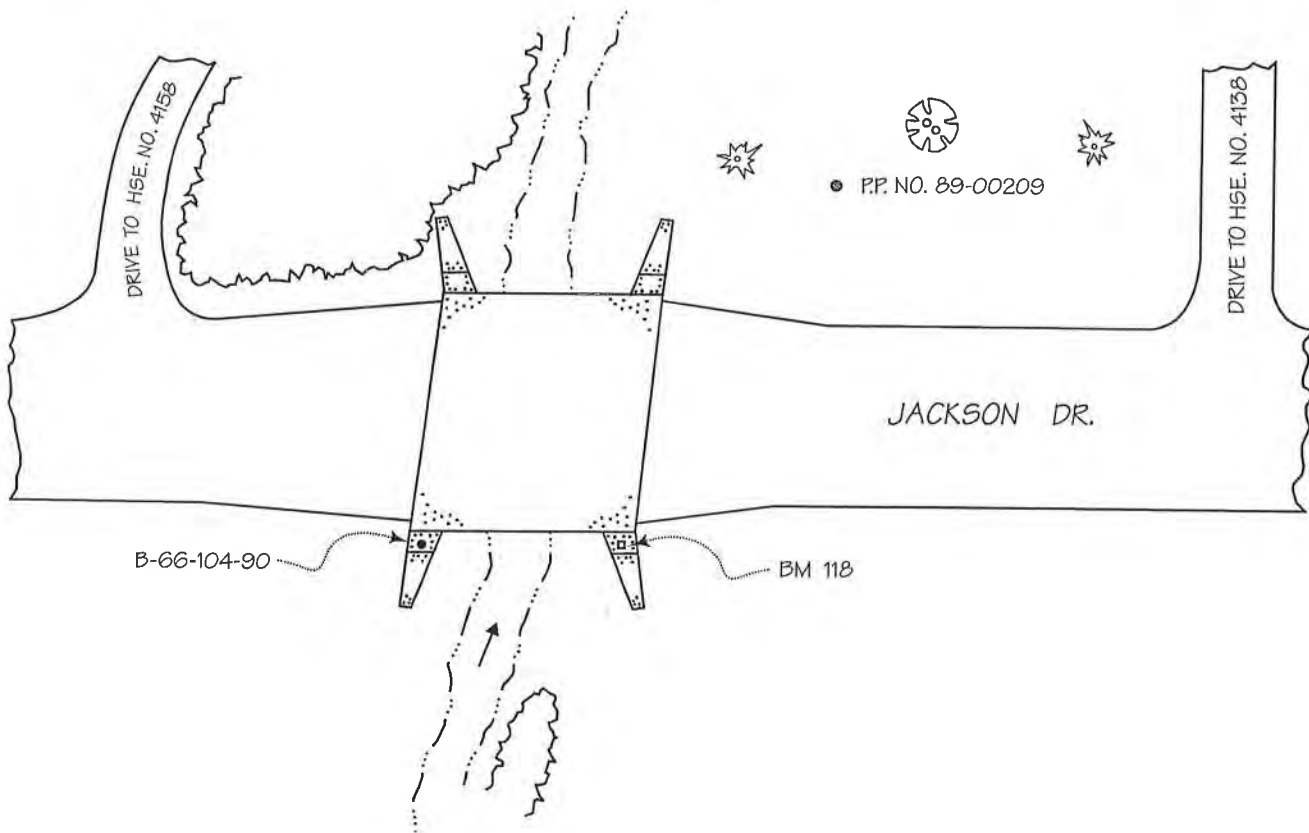
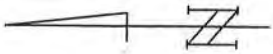

DETAILED DESCRIPTION:

BM 118 is a chiseled square in the top of the southwest concrete wingwall for bridge No. B-66-104-90.
B-66-104-90 is a Wisconsin Department of Transportation aluminum cap in the top of the northwest concrete wingwall of the bridge.

RECOVERED BY: SEWRPC DATE: 4 APRIL 2005

RECORD OF VERTICAL CONTROL STATION

SECTION 8 T. 10 N. R. 20 E. WASHINGTON COUNTY, WISCONSIN

BENCH MARK NO.: 119 ELEVATION 861.035

BM SET BY: AERO-METRIC, INC. YEAR: 2004

BM CONTROL SURVEY BY: AERO-METRIC, INC. YEAR: 2004

DATUM: NATIONAL GEODETIC VERTICAL DATUM OF 1929

CONTROL ACCURACY: SECOND ORDER, CLASS II

LOCATION SKETCH:

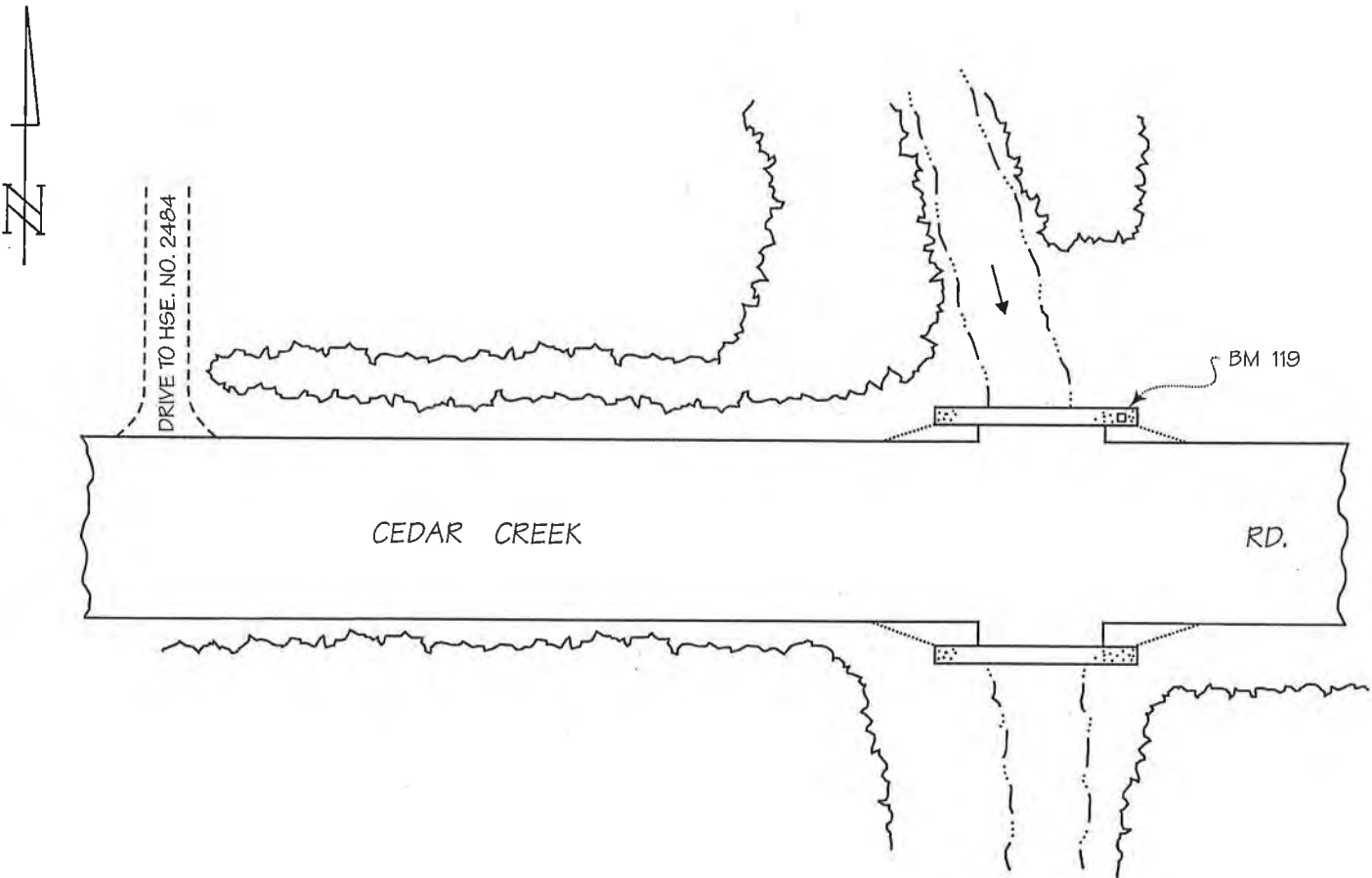

DETAILED DESCRIPTION:

BM 119 is a chiseled square in the top of the concrete headwall for bridge. The benchmark is 325'± east of the drive to house number 2484.

RECOVERED BY: SEWRPC DATE: 4 APRIL 2005

RECORD OF VERTICAL CONTROL STATION

SECTION 11 T. 10 N. R. 20 E. WASHINGTON COUNTY, WISCONSIN

BENCH MARK NO.: JACKSON E GPS ELEVATION 845.684

BM SET BY: WisDOT YEAR: 2001

BM CONTROL SURVEY BY: AERO-METRIC, INC. YEAR: 2004

DATUM: NATIONAL GEODETIC VERTICAL DATUM OF 1929

CONTROL ACCURACY: SECOND ORDER, CLASS II

LOCATION SKETCH:

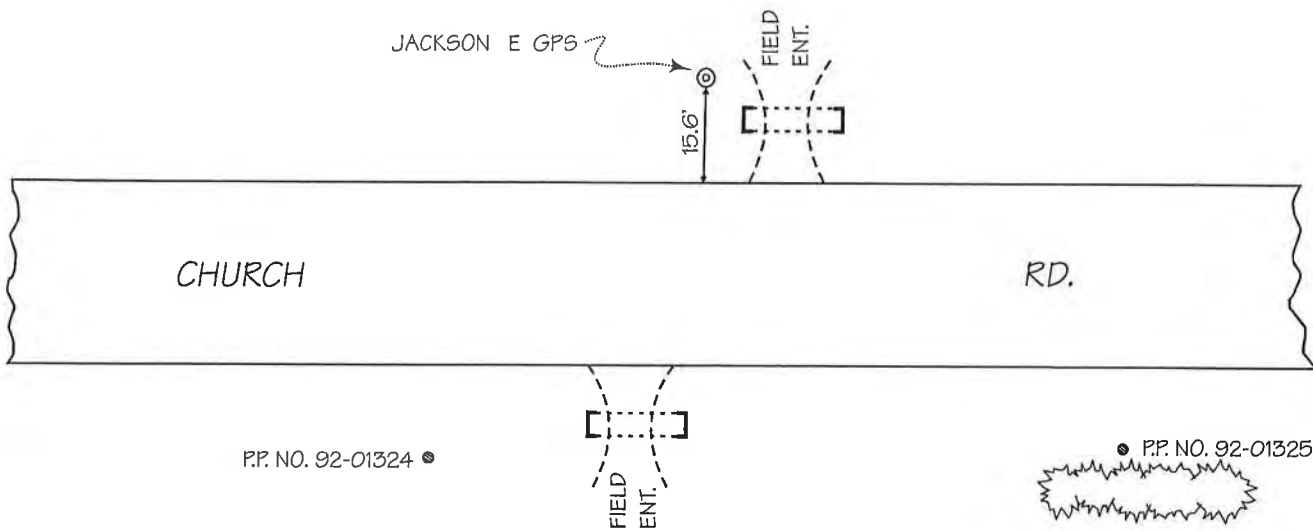

DETAILED DESCRIPTION:

JACKSON E GPS is a concrete monument with a Wisconsin Department of Transportation brass cap. The monument is 250'± south of the east quarter corner of Section 10, T10N R20E and 300'± north of the drive to house No. 4263.

RECOVERED BY: SEWRPC DATE: 4 APRIL 2005

RECORD OF VERTICAL CONTROL STATION

SECTION 15 T. 10 N. R. 20 E. WASHINGTON COUNTY, WISCONSIN

BENCH MARK NO.: 116 ELEVATION 841.117

REFERENCE BENCH MARK NO.: 116A ELEVATION 841.186

BM /RBM SET BY: AERO-METRIC, INC./WisDOT. YEAR: 2004/1990

BM/RBM CONTROL SURVEY BY: AERO-METRIC, INC./SEWRPC. YEAR: 2004/2005

DATUM: NATIONAL GEODETIC VERTICAL DATUM OF 1929

CONTROL ACCURACY: SECOND ORDER, CLASS II

LOCATION SKETCH:

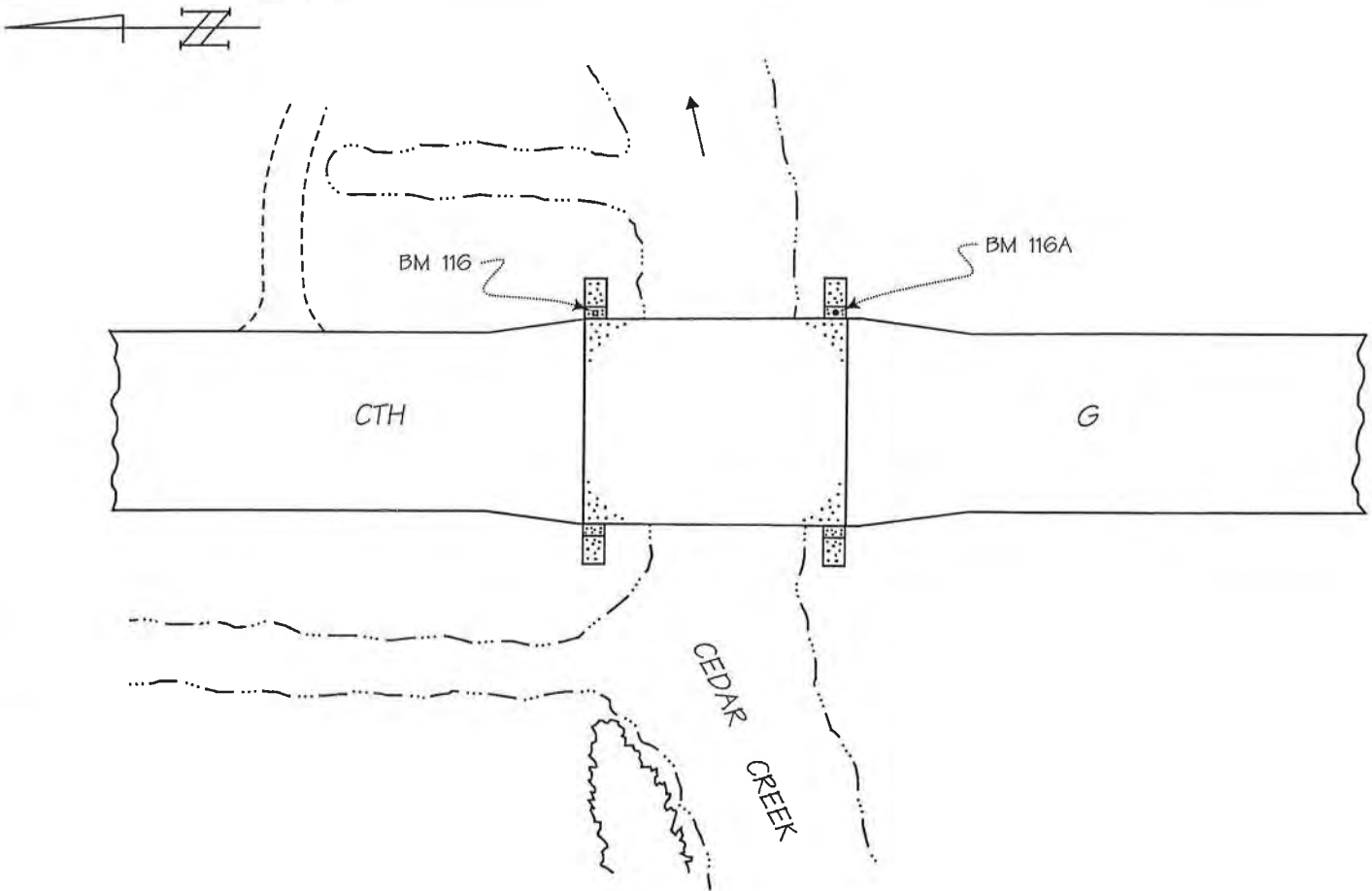

DETAILED DESCRIPTION:

BM 116 is a chiseled square in the top of the northeast concrete wingwall for bridge. The benchmark is 700' south of the northwest corner Section 15, T10N R20E.

BM 116A is Wisconsin Division of Highways aluminum cap set in the top of the southeast concrete wingwall for bridge.

RECOVERED BY: SEWRPC DATE: 4 APRIL 2005

RECORD OF VERTICAL CONTROL STATION

SECTION 31 T. 10 N. R. 20 E. WASHINGTON COUNTY, WISCONSIN

BENCH MARK NO.: 2X44 ELEVATION 927.277

BM SET BY: WisDOT YEAR: 1999

BM CONTROL SURVEY BY: AERO-METRIC, INC. YEAR: 2003

DATUM: NATIONAL GEODETIC VERTICAL DATUM OF 1929

CONTROL ACCURACY: SECOND ORDER, CLASS II

LOCATION SKETCH:

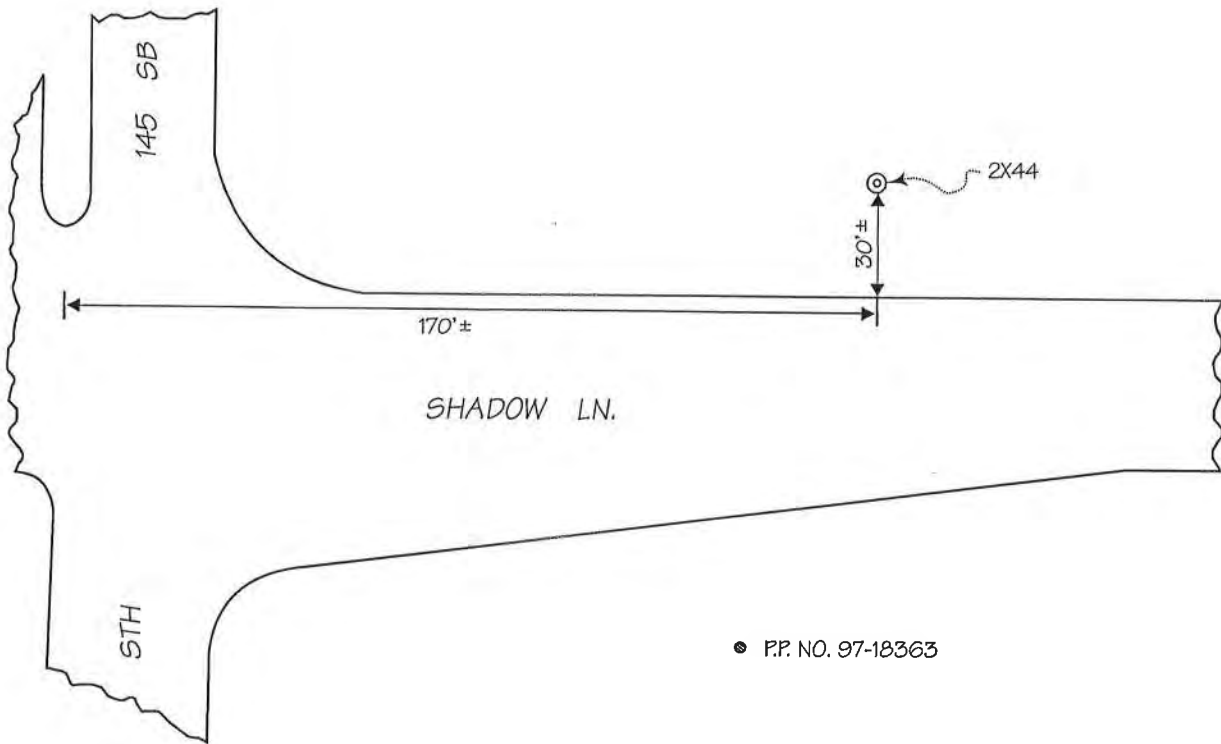
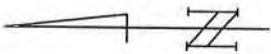

DETAILED DESCRIPTION:

2x44 is a concrete monument with WisDOT brass cap.

RECOVERED BY: SEWRPC DATE: 11 AUGUST 2003